



CROWN
LETS 4 U

FOR SALE



£274,950 Leasehold

2 BED FLAT **High Street, Thornton Heath, CR7**

Crown Lets 4u are delighted to present this first floor newly decorated modern two bed flat with private entrance and a separated modern kitchen. This beautiful property is near the Croydon University Hospital and located on Thornton Heath High Street, only 2 minute's walk to Thornton Heath BR Station, Iceland and Tesco Shopping Centre. This property is also a stone throw away from Thornton Heath Leisure Centre with gym and swimming pool activities just on your door step. The property benefits from a one double bedroom, generous size second bedroom, spacious lounge and a spacious modern family bathroom with hand wash basin, WC and a bathtub with above shower. The fully fitted modern kitchen comes with cooker, oven, fridge/freezer and washing machine. The property further benefits from double glazed windows, gas central heating and laminated flooring throughout. This property comes with no onward chain and it's in excellent condition.

This leasehold flat will have a 99 years lease, located on Thornton Heath High Street and also serve the surrounding area making it easily accessible to many buses and only two minutes' walk to Thornton Heath British Rail Station. Easy commuting to London Bridge / London Victoria, only 20 minutes by train.

- Newly Decorated
- Private Entrance
- 2 Bedrooms
- Spacious Lounge
- Modern Kitchen
- Modern Bathroom
- First Floor Flat
- Gas Central Heating
- Double Glazed
- Laminated Flooring
- Chain Free
- 99 Years Lease
- Located on High St

Croydon Office: Crown Lets 4u, 292 London Road, Croydon, Surrey, CR0 2TG

Tel: 020 8684 6677 Mob: 07540 874 532 Fax: 0872 115 6090 Email: info@crownlets4u.co.uk

www.crownlets4u.co.uk



EPC

MAP & POST CODE: CR7 8RY

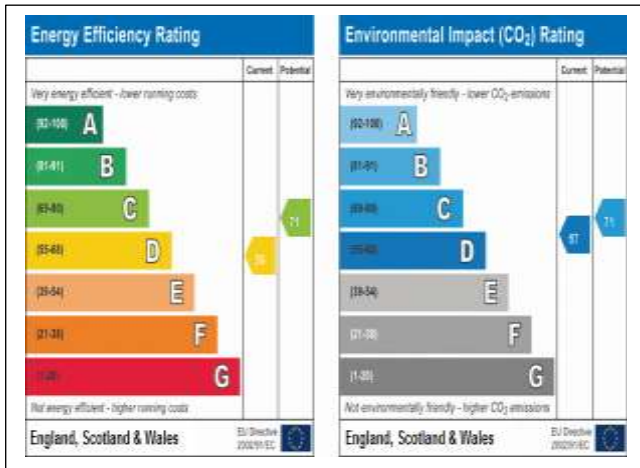

FLOOR PLANS

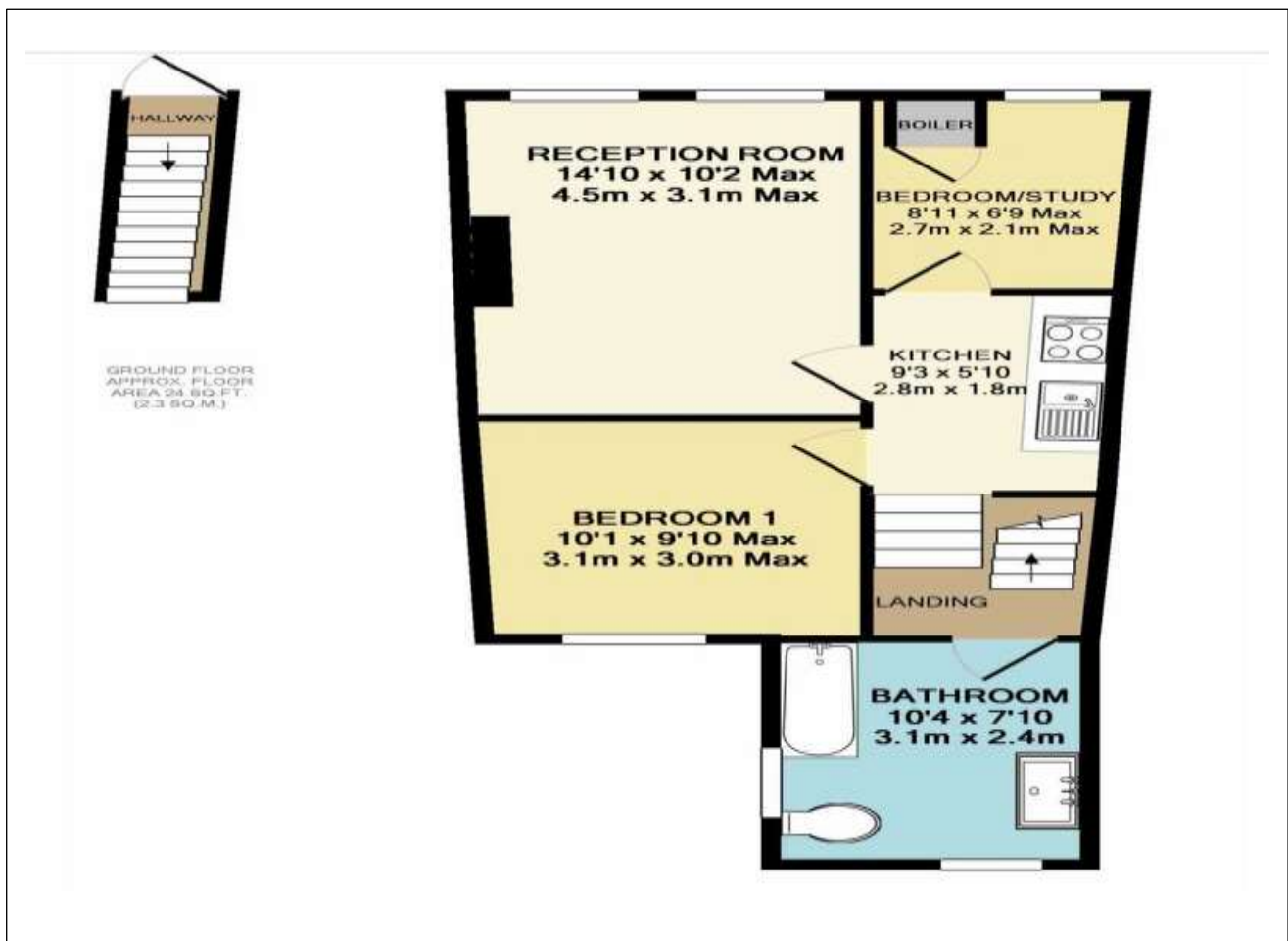

Croydon Branch: 292 London Road, Croydon, Surrey, CR0 2TG

Tel: 020 8684 6677 **Mob:** 07540 874 532 **Fax:** 0872 115 6090 **Email:** info@crownlets4u.co.uk

www.crownlets4u.co.uk